

# RECESSED CUT HOLE CEILING

For TLP-X/F/M/A/E Series



## BEFORE YOU BEGIN

Read these instructions completely and carefully.



### ⚠ WARNING/AVERTISSEMENT

#### RISK OF ELECTRIC SHOCK

- Turn power off before inspection, installation or removal.
- Properly ground electrical enclosure.

#### RISK OF FIRE

- Follow all NEC and local codes.
- Use only UL or IEC approved wire for input/output connections. Minimum size 18 AWG (0.75mm<sup>2</sup>).

#### RISQUES DE DÉCHARGES ÉLECTRIQUES

- Coupez l'alimentation avant d'inspecter, installer ou déplacer le luminaire.
- Assurez-vous de correctement mettre à la terre le boîtier d'alimentation électrique.

#### RISQUES D'INCENDIE

- Respectez tous les codes NEC et codes locaux.
- N'utilisez que des fils approuvés par UL ou IEC pour les entrées/sorties de connexion. Taille minimum 18 AWG (0.75mm<sup>2</sup>).

## Prepare Electrical Wiring

Refer to *TLP Series LED Panel Specification* for more lamp electronical data info.



#### Electrical Requirements

- The LED luminaire must be connected to the mains supply according to its ratings on the product label.



#### Grounding Instructions

- The grounding and bonding of the overall system shall be done in accordance to local electric code of the country where the luminaire is installed.

## Save These Instructions

Use only in the manner intended by the manufacturer. If you have any questions, contact the manufacturer.

### ⚠ CAUTION

Do not perforate the integrity of the luminaire. Only screw into the threaded mounting bracket holes located at the four corners of the fixture.

### ⚠ WARNING/AVERTISSEMENT

**Risk of Fire.** Do not install insulation within 3 inches (76 mm) of luminaire top.  
**Risques d'incendie.** Ne pas installer d'isolation à moins de 76 mm (3 pouces) au-dessus du luminaire.

## Storage Info

Environmental Operating Temperature Range

-10°C to +40°C

Environmental Rating

Dry location rated



Environmental Storage Temperature Range

-40°C to +60°C



www.sgslight.com | sales@sgslight.com

## CUT HOLE CEILING KITS

Items	TLP-TK4				TLP-TK6	
	3030	3060	6060	6262	3012	6012
		X 4			X 6	
		X 4			X 6	

## INSTALLATION STEPS

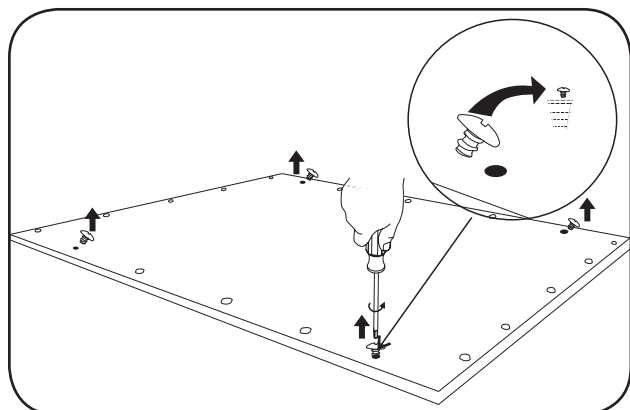

- 1 Unscrew the highlighted screws from the four corners of the LED Panel.

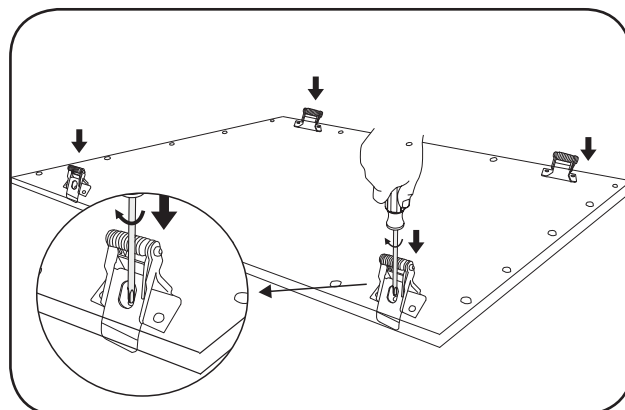

- 2 Place the springs in position and reinstall the four screws. (the screws must be inserted through the center hole of the clip as illustrated above).

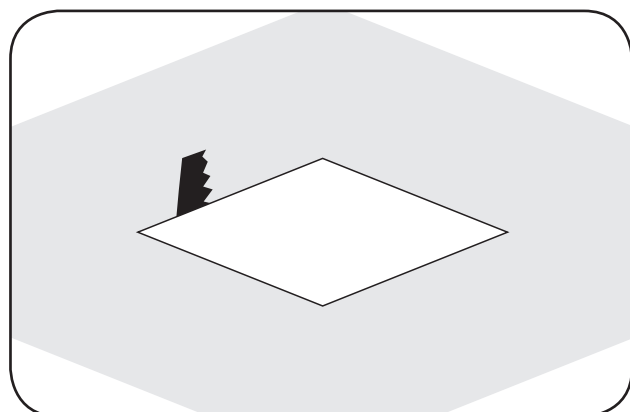

- 3 Cut a square hole in the ceiling 10mm smaller than the LED Panel.

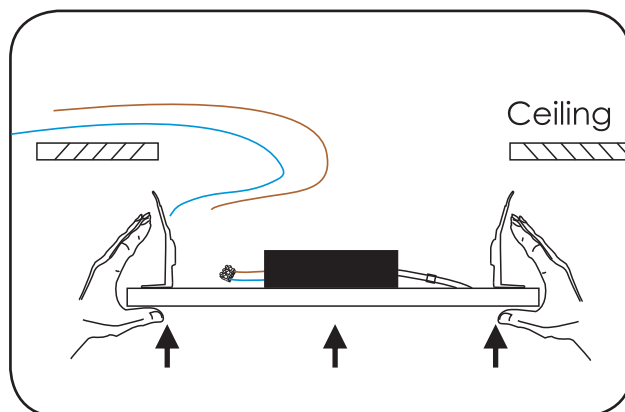

- 4 Connect the LED Driver to AC mains power. Push the LED Panel into the ceiling cavity with the springs raised.

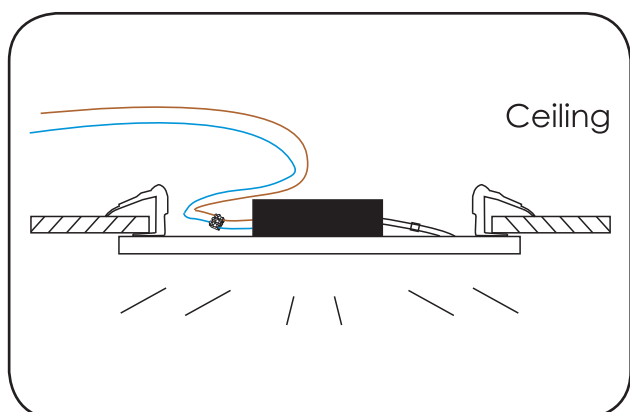

- 5 Complete installation.