

To replace PL-L 4 Pin

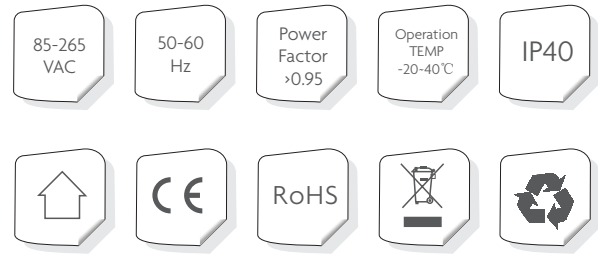

Features & Benefits

- 2835 SMD LEDs with high lumen efficiency > 100 LM/W.
- Optimum light uniformity and high color homogeneity.
- Extremely robust with aluminum heat sink and polycarbonate cover.
- Power Factor: >0.95.
- Overpower, short and open circuit protected.
- NO noise, NO flicker, NO UV and IR.
- Mercury-free and RoHS compliant.
- Comply with CE, FCC and UL standards.

Part No.	Length	Wattage	LED QTY.	Lumens	Replace PHILIPS
PL08-S07-4060W-H0	227mm	8W	60LEDs	750-800LM	PL-L-18W
PL12-S07-4084W-H0	322mm	12W	84LEDs	1100-1200LM	PL-L-24W
PL15-S07-4120W-H0	417mm	15W	120LEDs	1500-1600LM	PL-L-36W
PL18-S07-4120W-H0	417mm	18W	120LEDs	1800-2000LM	PL-L-40W
PL18-S07-4144W-H0	542mm	18W	144LEDs	1800-2000LM	PL-L-40W
PL22-S07-4144W-H0	542mm	22W	144LEDs	2200-2450LM	PL-L-55W

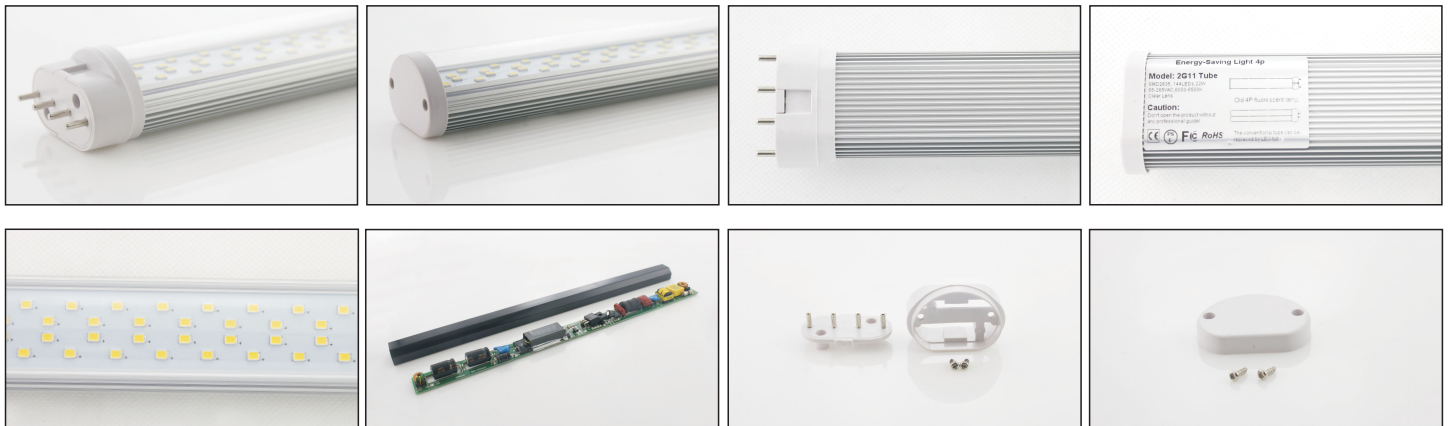

Dimension

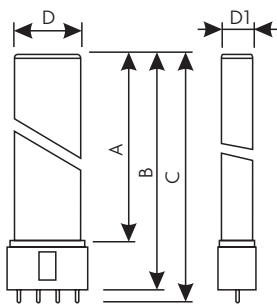

Power	A:MAX (mm)	B:MAX (mm)	C:MAX (mm)	D:MAX (mm)	D1:MAX (mm)
8W	201	220	227	38	17
12W	296	315	322	38	17
15W	391	410	417	38	17
18W	391	410	417	38	17
18W	516	535	542	38	17
22W	516	535	542	38	17

To replace PL-L 4 Pin

Technical Specifications

Physical Specifications

Length	227mm	322mm	417mm	542mm
Weight	173g	189g	254g	303g
Housing	Aluminum Base+PC Cover			
Lens	Clear/Milky			
Base Type	2G11 4 Pin			
Work Environment	Indoor use (applicable for dry environment)			

Electrical Specifications

	227mm	322mm	417mm	417mm	542mm	542mm
LED Quantity	60LEDs	84LEDs	120LEDs	120LEDs	144LEDs	144LEDs
Power Consumption	8W	12W	15W	18W	18W	22W
Input Voltage	85-265VAC					
Power Factor	>0.95					
Light Source	2835 SMD LEDs, more than 21 LM each					
Operation Temperature	-20~40°C					

Optical Specifications

		227mm	322mm	417mm	417mm	542mm	542mm
Power Consumption		8W	12W	15W	18W	18W	22W
Lumens	Clear	780 ±10%LM	1200 ±10%LM	1545 ±10%LM	1870 ±10%LM	1870 ±10%LM	2400 ±10%LM
	Milky	770 ±10%LM	1150 ±10%LM	1500 ±10%LM	1800 ±10%LM	1800 ±10%LM	2350 ±10%LM
Luminous Efficiency	Clear	98LM/W	100LM/W	103LM/W	104LM/W	104LM/W	109LM/W
	Milky	96LM/W	96LM/W	100LM/W	100LM/W	100LM/W	107LM/W
Color Temperature		Warm White: 2800K-3200K					
		Natural White: 3900K-4300K					
		Cool White: 5600K-6200K					
CRI		>80					
Beam Angle		120 Degree					

To replace PL-L 4 Pin

Advantage

Optic Lens

- Clear/Milky cover for optimum light uniformity
- TEIJIN Polycarbonate material
- Light transmittance > 90%
- 94-V0 approved

SMD LEDs

- High brightness 2835 SMD LEDs
- High color homogeneity

LED Driver

- Isolated driver
- Efficiency > 88%
- Power Factor > 0.95
- Constant Current fluctuation < 3%

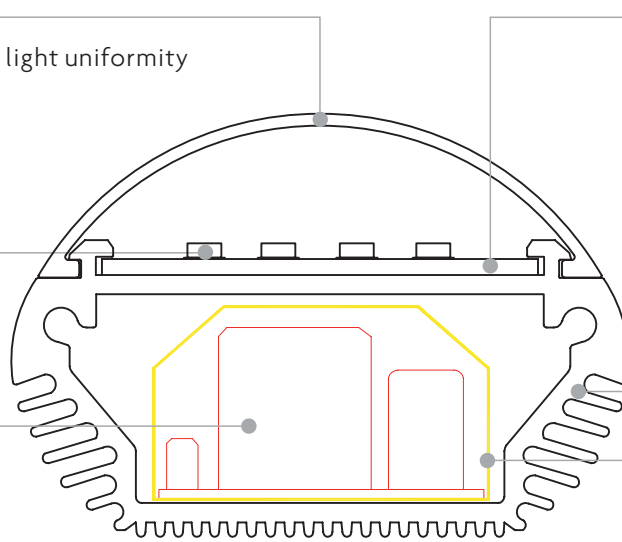

- #### MC-PCB & Thermal conductive silicon
- For optimal thermal transmission

- #### Aluminium Heatsink
- Patent design for optimal thermal transmission
 - High-grade exterior

- #### Insulated Casing
- Safety protection
 - Pass 3750V high voltage testing

Photometric Data

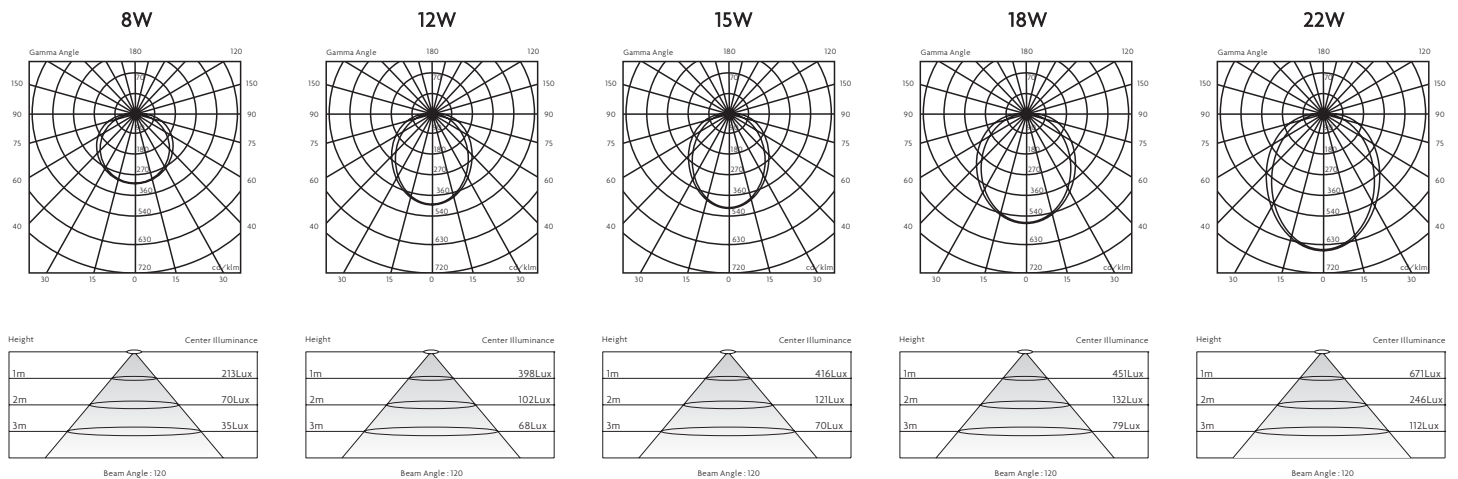

To replace PL-L 4 Pin

Ordering Number Logic

PL--22-----S-----0-----7-----4-----144-----WW----H0

Wattage	Tube Type	Cover Type	Base Type	LED Type	LED QTY	Color Temp.	Input Voltage
22W	S: Single tube D: Double tube	0: Clear 1: Milky	7: 2G11	1: 3528 2: 3022 3: 3014 4: 2835	144	Warm White Natural White Cool White	H0: 85-277VAC H1: 95-140VAC H2: 180-265VAC

Ordering Information

Part Number	Description	Unit
PL08-S07-4060W-H0	LumiT 2G11 LED Tube, 8W, 220mm, Clear Lens, 60 SMD2835 LEDs, Warm White, 85-265VAC.	PCS
PL08-S07-4060N-H0	LumiT 2G11 LED Tube, 8W, 220mm, Clear Lens, 60 SMD2835 LEDs, Natural White, 85-265VAC.	PCS
PL08-S07-4060C-H0	LumiT 2G11 LED Tube, 8W, 220mm, Clear Lens, 60 SMD2835 LEDs, Cool White, 85-265VAC.	PCS
PL12-S07-4084W-H0	LumiT 2G11 LED Tube, 12W, 315mm, Clear Lens, 84 SMD2835 LEDs, Warm White, 85-265VAC.	PCS
PL12-S07-4084N-H0	LumiT 2G11 LED Tube, 12W, 315mm, Clear Lens, 84 SMD2835 LEDs, Natural White, 85-265VAC.	PCS
PL12-S07-4084C-H0	LumiT 2G11 LED Tube, 12W, 315mm, Clear Lens, 84 SMD2835 LEDs, Cool White, 85-265VAC.	PCS
PL15-S07-4120W-H0	LumiT 2G11 LED Tube, 15W, 410mm, Clear Lens, 120 SMD2835 LEDs, Warm White, 85-265VAC.	PCS
PL15-S07-4120N-H0	LumiT 2G11 LED Tube, 15W, 410mm, Clear Lens, 120 SMD2835 LEDs, Natural White, 85-265VAC.	PCS
PL15-S07-4120C-H0	LumiT 2G11 LED Tube, 15W, 410mm, Clear Lens, 120 SMD2835 LEDs, Cool White, 85-265VAC.	PCS
PL18-S07-4120W-H0	LumiT 2G11 LED Tube, 18W, 410mm, Clear Lens, 120 SMD2835 LEDs, Warm White, 85-265VAC.	PCS
PL18-S07-4120N-H0	LumiT 2G11 LED Tube, 18W, 410mm, Clear Lens, 120 SMD2835 LEDs, Natural White, 85-265VAC.	PCS
PL18-S07-4120C-H0	LumiT 2G11 LED Tube, 18W, 410mm, Clear Lens, 120 SMD2835 LEDs, Cool White, 85-265VAC.	PCS
PL18-S07-4144W-H0	LumiT 2G11 LED Tube, 18W, 535mm, Clear Lens, 144 SMD2835 LEDs, Warm White, 85-265VAC.	PCS
PL18-S07-4144N-H0	LumiT 2G11 LED Tube, 18W, 535mm, Clear Lens, 144 SMD2835 LEDs, Natural White, 85-265VAC.	PCS
PL18-S07-4144C-H0	LumiT 2G11 LED Tube, 18W, 535mm, Clear Lens, 144 SMD2835 LEDs, Cool White, 85-265VAC.	PCS
PL22-S07-4144W-H0	LumiT 2G11 LED Tube, 22W, 535mm, Clear Lens, 144 SMD2835 LEDs, Warm White, 85-265VAC.	PCS
PL22-S07-4144N-H0	LumiT 2G11 LED Tube, 22W, 535mm, Clear Lens, 144 SMD2835 LEDs, Natural White, 85-265VAC.	PCS
PL22-S07-4144C-H0	LumiT 2G11 LED Tube, 22W, 535mm, Clear Lens, 144 SMD2835 LEDs, Cool White, 85-265VAC.	PCS

Package

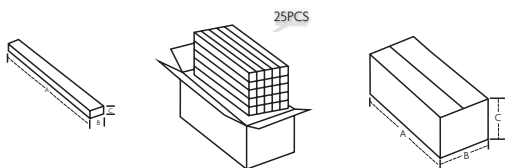

Tube	Box		Carton	
	Length	ABC:MAX (cm)	ABC:MAX (cm)	Gross Weight (kg)
227mm	24X5X4	0.25	26X26X19	6.5
322mm	34X5X4	0.28	35X26X19	7.5
417mm	43X5X4	0.32	45X26X19	8.5
542mm	56X5X4	0.35	57X26X19	9